

Charles Jodon

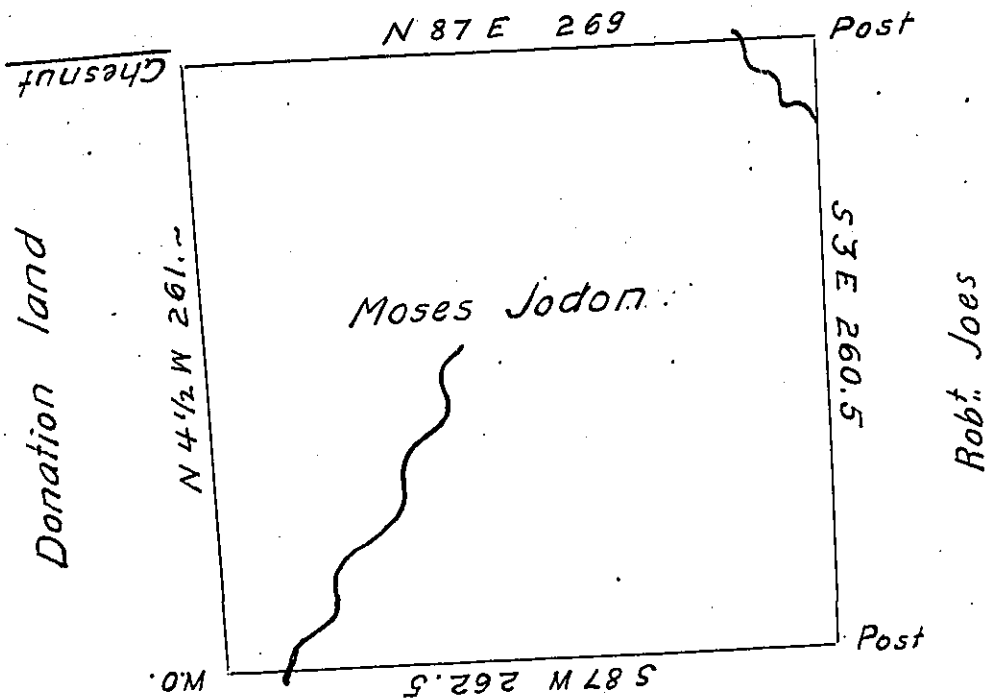

Timothy Jodon

Situate on the Waters of Beaver Creek in distrist N^o. 3
 Allegany County Containing 408^{ac}. 16 P^s and allowance Surveyed
 the 21 May 1795 in pursuance of a Warrant granted Moses Jodon
 21 Apr^l. 1794.

Ben. Stokely D.S.

Dan^l. Brodhead Esq. S.G.

IN TESTIMONY that the above is a copy of the original remaining on file in
 the Department of Internal Affairs of Pennsylvania, made
 conformably to an Act of Assembly approved the 16th day of
 February, 1833, I have hereunto set my Hand and caused
 the Seal of said Department to be affixed at Harrisburg,
 this thirty first day of May 1905

Loae R. Purson
 Secretary of Internal Affairs.